



Premium Hand Tools

Spanners



Pliers



Wrenches



Automotive Tools



Agriculture Parts



**PRODUCT
CATALOGUE**



Premium Hand Tools

Ever since, 1979, the company has been manufacturing PRECISION (in its metonymy terms) and HIGH CLASS QUALITY HAND TOOLS. We have all along been dedicately involved to serve a large number of recognized brands for the last more than 30 years.

The skills of Management lies not only in day to day multiplying its business but to retain the very values of business in terms of "GOOD WILL" and CUSTOMER'S SATISFACTION. This very fact stands proved from the rolls of its WORK FORCE. This majority of our workmen has been as old as the unit itself and has tenaciously been working for the company as its integral part.

WHAT IT SPEAKS AFTER ALL? It tacitly speaks of Business Qualifications coupled with invincible experience and intellect of the "MANAGEMENT".

Any businessman with a little business acumen will acquiesce that "IT IS EASIER TO BUILD UP A HOUSE CUM HOME BUT DIFFICULT TO MAINTAIN THE SAME WITH SAME INITIAL enthusiastic SPIRIT AND STILL MORE DIFFICULT TO RETAIN THE DIFFERENT INGREDIENTS gladly and willingly TOGETHER CREATING THEREBY HOMELY and CONGENIAL ATMOSPHERE without the support of required VERSATILE AND VARIED WIT.

It could become possible with us only for the Management knows and has been affording full material and job - satisfaction to its vertebrate elements like, work force, customers, supporters / suppliers and its all other ancillaries.

Primarily, when 'ESS ESS FORGINGS' was set-up, it was tiny unit over a period of time HAPPY MACHINE TOOLS - with similar production plans and programs - came into being as its one of the ancillary units. In both of these units, we have been producing and supplying HAND TOOLS, Spanners, Wrenches, Pliers and More.

SUNIL GOYAL
Managing Director





INDEX

Combination Spanners	04 - 08
Combination Spanners (Shallow Offset)	09 - 11
Double Open End Spanners	12 - 15
Bi-Hexagon Ring Spanners	16 - 19
Obstruction Wrench (S-Type & Half Moon Type)	20 - 21
Flare Nut Wrench, Torx Double Ended Ring Wrench, Stubby Wrench	22
Packaging	23 - 27
Automotive Tools	28 - 31
Wrenches	32 - 33
Pliers	34 - 35
Cutters & Pincers	36
Wrecking Bars & Chisels	37
Hammers	38 - 39
Lubricating Tools	40 - 41
Carpentry Tools	42 - 43
Vices	44
Hacksaws	45
Agriculture Parts	46
Infrastructure	47

WARNING !



Do not use metric wrenches on imperial bolts & vice versa

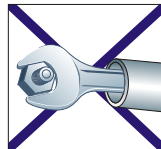

Do not use extensions to increase the applied torque (especially on wrenches)

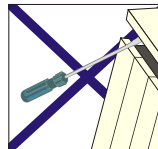

Do not use any tool as a lever, chisel or punch if not designed for this purpose

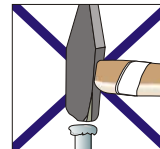

Do not use worn out or damaged tools



Make sure that tool size correspond to the size of the part to be operated

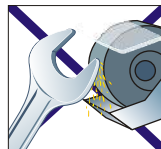

Do not modify tools

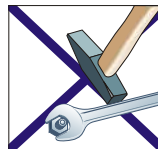

Do not strike tools to increase power if not designed for this purpose

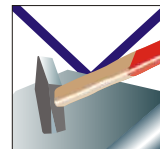

Do not use striking tools on surface harder than the striking face



Premium Hand Tools

SS-2001

COMBINATION SPANNERS - LONG PATTERN

- RECESSED PANEL
- RING 15° OFFSET
- CARBON / CHROME VANADIUM STEEL
- DULY HARDENED AND TEMPERED
- CONFIRMS TO **DIN-3113A**



NICKEL CHROME PLATED

SIZES mm	LENGTH mm	WEIGHT gms (Approx.)
6	100	15
7	110	18
8	120	25
9	130	30
10	140	35
11	150	50
12	160	55
13	170	60
14	180	75
15	190	90
16	200	95
17	210	120
18	220	140
19	230	155
20	240	185
21	250	195
22	260	215
23	270	240
24	280	285
25	290	310
26	300	340
27	310	375
28	320	385
29	330	425
30	340	465
32	360	540

CODE	SETS IN MM	WEIGHT gms (Approx.)
60 M	8, 10, 12, 13, 14, 17	370
80 M	8, 9, 10, 11, 13, 14, 17, 19	550
110 M	6, 7, 8, 9, 10, 11, 12, 13, 14, 17, 19	638
120M	6, 7, 8, 9, 10, 11, 12, 13, 14, 17, 19, 22	853
140M	6, 7, 8, 9, 10, 11, 12, 13, 14, 15, 17, 18, 19, 22	1083
14M	8, 9, 10, 11, 12, 13, 14, 15, 17, 18, 19, 22, 23, 24	1190
250M	6, 7, 8, 9, 10, 11, 12, 13, 14, 15, 16, 17, 18, 19, 20, 21, 22, 23, 24, 25, 26, 27, 28, 30, 32	4500

Also available in SAE sizes

ALSO AVAILABLE



NOTE :

Finish to Order : Head / Matt Polished
Packing to Order : Bulk or Individual Carton or Clip or Pouch/Wallet/Skin/Shrink/ Blister/ Window box.

**TORQUE MEETS AND EXCEEDS
 DIN STANDARD.**

SEE PACKING ON PAGE NO. 23-27



SS-2003

COMBINATION SPANNER (Raised Panel)

- RING 15° OFFSET
- CHROME VANADIUM STEEL
- DULY HARDENED AND TEMPERED
- CONFIRMS TO **ANSI**



NICKEL CHROME PLATED

SIZES		LENGTH mm	WEIGHT gms (Approx.)
mm	SAE		
6	1/4	95	16
7		98	20
8	5/16	107	28
9		118	30
10	3/8	126	40
11	7/16	132	45
12		138	54
13	1/2	146	65
14	9/16	165	80
15		175	90
16	5/8	185	105
17	11/16	205	135
18		217	150
19	3/4	230	165
20		230	165
21	13/16	260	200
22	7/8	290	230
23		300	250
24	15/16	315	300
25	1	325	325
26		360	350
27	1.1/16	362	380
28	1.1/8	372	450
30		377	500
32	1.1/4	392	565

CODE	SETS IN MM	WEIGHT gms (Approx.)
60 M	8, 10, 12, 13, 14, 17	402
80 M	8, 9, 10, 11, 13, 14, 17, 19	581
110 M	6, 7, 8, 9, 10, 11, 12, 13, 14, 17, 19	671
120M	6, 7, 8, 9, 10, 11, 12, 13, 14, 17, 19, 22	886
140M	6, 7, 8, 9, 10, 11, 12, 13, 14, 15, 17, 18, 19, 22	1126
14M	8, 9, 10, 11, 12, 13, 14, 15, 17, 18, 19, 22, 23, 24	1250
250M	6, 7, 8, 9, 10, 11, 12, 13, 14, 15, 16, 17, 18, 19, 20, 21, 22, 23, 24, 25, 26, 27, 28, 30, 32	4536
SETS IN SAE		
50A	3/8, 7/16, 1/2, 9/16, 5/8	328
110A	1/4, 5/16, 3/8, 7/16, 1/2, 9/16, 5/8, 11/16, 3/4, 13/16, 7/8	1072
120A	1/4, 5/16, 3/8, 7/16, 1/2, 9/16, 5/8, 11/16, 3/4, 13/16, 7/8, 1"	1342
140A	1/4, 5/16, 3/8, 7/16, 1/2, 9/16, 5/8, 11/16, 3/4, 13/16, 7/8, 15/16, 1, 1.1/4	2222

ALSO AVAILABLE



NOTE :
Finish to Order : Head and Panel Polished
Packing to Order : Bulk or Individual Carton or Clip or Pouch/Wallet/Skin/Shrink/ Blister/ Window box.

TORQUE MEETS AND EXCEEDS ANSI STANDARD.

SEE PACKING ON PAGE NO. 23-27



Premium Hand Tools

SS-2004

COMBINATION SPANNERS

- PRESS PANEL
- RING 15° OFFSET
- CHROME VANADIUM STEEL
- DULY HARDENED AND TEMPERED
- CONFIRMS TO **DIN-3113A**

**COLD COINED
& STAMPED**



NICKEL CHROME PLATED

SIZES mm	LENGTH mm	WEIGHT gms (Approx.)
6	100	18
7	110	22
8	120	26
9	130	30
10	140	42
11	150	52
12	160	60
13	170	72
14	180	86
15	190	92
16	200	109
17	210	132
18	220	152
19	230	160
20	240	182
21	250	192
22	260	210
23	270	250
24	280	260
25	290	300
26	300	320
27	310	390
28	320	435
29	330	435
30	340	460
32	360	560

CODE	SETS IN MM	WEIGHT gms (Approx.)
60 M	8, 10, 12, 13, 14, 17	418
80 M	8, 9, 10, 11, 13, 14, 17, 19	600
110 M	6, 7, 8, 9, 10, 11, 12, 13, 14, 17, 19	700
120M	6, 7, 8, 9, 10, 11, 12, 13, 14, 17, 19, 22	910
140M	6, 7, 8, 9, 10, 11, 12, 13, 14, 15, 17, 18, 19, 22	1154
14M	8, 9, 10, 11, 12, 13, 14, 15, 17, 18, 19, 22, 23, 24	1225
250M	6, 7, 8, 9, 10, 11, 12, 13, 14, 15, 16, 17, 18, 19, 20, 21, 22, 23, 24, 25, 26, 27, 28, 30, 32	4612

ALSO AVAILABLE



CONVENTIONAL BROACH

NOTE :

Finish to Order : Head Polished / Satin / Matt
Packing to Order : Bulk or Individual Carton or Clip or Pouch/Wallet/Skin/Shrink/ Blister/ Window box.

**TORQUE MEETS AND EXCEEDS
DIN STANDARD.**

SEE PACKING ON PAGE NO. 23-27



SS-2005 (ESS-105)

COMBINATION SPANNER (Elliptical Pattern)

- RING 15° OFFSET
- CHROME VANADIUM STEEL
- DULY HARDENED AND TEMPERED
- CONFIRMS TO **DIN-3113A**



Also Available



SATIN FINISH



BLACK SATIN FINISH



GOLD SATIN FINISH



NICKEL CHROME PLATED

SIZES		LENGTH mm	WEIGHT gms (Approx.)
mm	SAE		
6	1/4	100	18
7		110	22
8	5/16	120	26
9		130	30
10	3/8	140	42
11	7/16	150	52
12		160	60
13	1/2	170	72
14	9/16	180	86
15		190	92
16	5/8	200	109
17	11/16	210	132
18		220	152
19	3/4	230	160
20		240	182
21	13/16	250	192
22	7/8	260	210
23		270	250
24	15/16	280	260
25	1	290	300
26		300	320
27	1.1/16	310	390
28	1.1/8	320	435
29		330	435
30		340	460
32	1.1/4	360	560

CODE	SETS IN MM	WEIGHT gms (Approx.)
60 M	8, 10, 12, 13, 14, 17	418
80 M	8, 9, 10, 11, 13, 14, 17, 19	600
110 M	6, 7, 8, 9, 10, 11, 12, 13, 14, 17, 19	700
120M	6, 7, 8, 9, 10, 11, 12, 13, 14, 17, 19, 22	910
140M	6, 7, 8, 9, 10, 11, 12, 13, 14, 15, 17, 18, 19, 22	1154
250M	6, 7, 8, 9, 10, 11, 12, 13, 14, 15, 16, 17, 18, 19, 20, 21, 22, 23, 24, 25, 26, 27, 28, 30, 32	4612



Also available in
SOFT GRIP SPANNERS

NOTE :
Finish to Order : Full Polished / Satin / Satin Gold
Packing to Order : Bulk or Individual Carton or Clip or Pouch/Wallet/Skin/Shrink/ Blister/ Window box.

**TORQUE MEETS AND EXCEEDS
DIN STANDARD.**

SEE PACKING ON PAGE NO. 23-27



Premium Hand Tools

SS-2006

COMBINATION SPANNER (Elliptical Panel)

- RING 15° OFFSET
- CHROME VANADIUM STEEL
- DULY HARDENED AND TEMPERED
- CONFIRMS TO ANSI



NICKEL CHROME PLATED

SIZES		LENGTH mm	WEIGHT gms (Approx.)
mm	SAE		
6	1/4	95	16
7		98	20
8	5/16	107	28
9		118	30
10	3/8	126	40
11	7/16	132	45
12		138	54
13	1/2	146	65
14	9/16	165	80
15		175	90
16	5/8	185	105
17	11/16	205	135
18		217	170
19	3/4	230	190
20		230	230
21	13/16	260	260
22	7/8	290	305
23		300	315
24	15/16	315	330
25	1	325	350
26		360	400
27	1.1/16	362	425
28	1.1/8	372	500
30		377	550
32	1.1/4	392	600

CODE	SETS IN MM	WEIGHT gms (Approx.)
60 M	8, 10, 12, 13, 14, 17	350
80 M	8, 9, 10, 11, 13, 14, 17, 19	630
110 M	6, 7, 8, 9, 10, 11, 12, 13, 14, 17, 19	730
120M	6, 7, 8, 9, 10, 11, 12, 13, 14, 17, 19, 22	1035
140M	6, 7, 8, 9, 10, 11, 12, 13, 14, 15, 17, 18, 19, 22	1310
250M	6, 7, 8, 9, 10, 11, 12, 13, 14, 15, 16, 17, 18, 19, 20, 21, 22, 23, 24, 25, 26, 27, 28, 30, 32	5385
SETS IN SAE		
50A	3/8, 7/16, 1/2, 9/16, 5/8	
110A	1/4, 5/16, 3/8, 7/16, 1/2, 9/16, 5/8, 11/16, 3/4, 13/16, 7/8	328
120A	1/4, 5/16, 3/8, 7/16, 1/2, 9/16, 5/8, 11/16, 3/4, 13/16, 7/8, 1"	1072
140A	1/4, 5/16, 3/8, 7/16, 1/2, 9/16, 5/8, 11/16, 3/4, 13/16, 7/8, 15/16, 1, 1.1/4	1342 2222

ALSO AVAILABLE



NOTE :

Finish to Order : Fully Polished
Packing to Order : Bulk or Individual Carton or Clip or Pouch/Wallet/Skin/Shrink/ Blister/ Window box.

TORQUE MEETS AND EXCEEDS DIN STANDARD.

SEE PACKING ON PAGE NO. 23-27



SS-2051

COMBINATION SPANNERS - SHALLOW OFFSET

- RECESSED PANEL
- RING 25° OFFSET
- CHROME VANADIUM STEEL
- DULY HARDENED AND TEMPERED

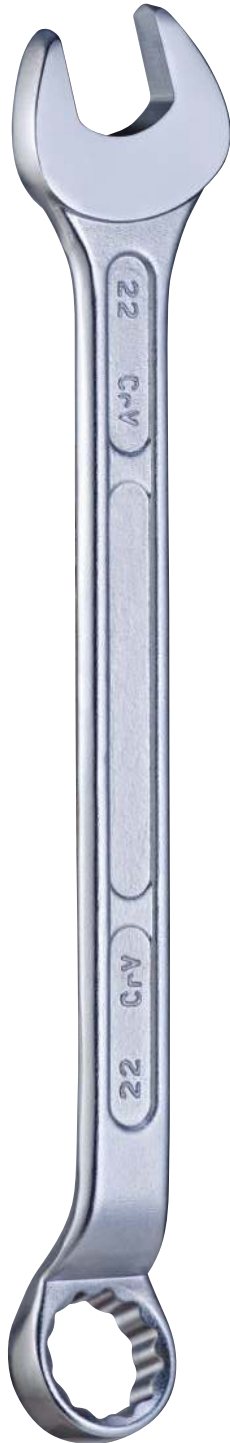

NICKEL CHROME PLATED

SIZES		LENGTH mm	WEIGHT gms (Approx.)
mm	SAE		
5	-	86	13
5.5	-	90	14
6	1/4	96	17
7		100	21
8	5/16	108	26
9		120	30
10	3/8	135	37
11	7/16	145	45
12		155	54
13	1/2	170	65
14	9/16	180	82
15		195	98
16	5/8	200	110
17	11/16	215	137
18		231	144
19	3/4	244	169
20		254	176
21	13/16	271	207
22	7/8	282	232
23		282	235
24	15/16	307	285
25	1	335	340
26		335	340
27	1.1/16	347	400
28	1.1/8	360	438
29		360	440
30		386	525
32	1.1/4	409	600

CODE	SETS IN MM	WEIGHT gms (Approx.)
60 M	8, 10, 12, 13, 14, 17	400
80 M	8, 9, 10, 11, 13, 14, 17, 19	605
110 M	6, 7, 8, 9, 10, 11, 12, 13, 14, 17, 19	670
120M	6, 7, 8, 9, 10, 11, 12, 13, 14, 17, 19, 22	895
140M	6, 7, 8, 9, 10, 11, 12, 13, 14, 15, 17, 18, 19, 22	1155
250M	6, 7, 8, 9, 10, 11, 12, 13, 14, 15, 16, 17, 18, 19, 20, 21, 22, 23, 24, 25, 26, 27, 28, 30, 32	4805

Also available in SAE Sizes

ALSO AVAILABLE



NOTE :
Finish to Order : Head Polished / Matt / Satin
Packing to Order : Bulk or Individual Carton or Clip or Pouch/Wallet/Skin/Shrink/ Blister/ Window box.

**TORQUE MEETS AND EXCEEDS
 DIN STANDARD.**

SEE PACKING ON PAGE NO. 23-27



Premium Hand Tools

SS-2052

COMBINATION SPANNERS - SHALLOW OFFSET

- PRESS PANEL
- RING 25° OFFSET
- CHROME VANADIUM STEEL
- DULY HARDENED AND TEMPERED

**COLD COINED
& STAMPED**



NICKEL CHROME PLATED

SIZES		LENGTH mm	WEIGHT gms (Approx.)
mm	SAE		
5	-	86	17
5.5	-	90	17
6	1/4	96	19
7		100	23
8	5/16	108	28
9		120	30
10	3/8	135	40
11	7/16	145	50
12		155	60
13	1/2	170	75
14	9/16	180	95
15		195	110
16	5/8	200	125
17	11/16	215	150
18		231	150
19	3/4	244	165
20		254	185
21	13/16	271	210
22	7/8	282	250
23		282	285
24	15/16	307	310
25	1	335	355
26		335	420
27	1.1/16	347	450
28	1.1/8	360	455
29		360	525
30		386	620
32	1.1/4	409	680

CODE	SETS IN MM	WEIGHT gms (Approx.)
60 M	8, 10, 12, 13, 14, 17	445
80 M	8, 9, 10, 11, 13, 14, 17, 19	650
110 M	6, 7, 8, 9, 10, 11, 12, 13, 14, 17, 19	750
120M	6, 7, 8, 9, 10, 11, 12, 13, 14, 17, 19, 22	1030
140M	6, 7, 8, 9, 10, 11, 12, 13, 14, 15, 17, 18, 19, 22	1305
250M	6, 7, 8, 9, 10, 11, 12, 13, 14, 15, 16, 17, 18, 19, 20, 21, 22, 23, 24, 25, 26, 27, 28, 30, 32	5695

Also available in SAE Sizes

ALSO AVAILABLE



CONVENTIONAL BROACH

NOTE :
Finish to Order : Head Polished / Matt / Satin
Packing to Order : Bulk or Individual Carton or Clip or Pouch/Wallet/Skin/Shrink/ Blister/ Window box.

**TORQUE MEETS AND EXCEEDS
DIN STANDARD.**

SEE PACKING ON PAGE NO. 23-27



SS-2053

COMBINATION SPANNERS - SHALLOW OFFSET

- RING 25° OFFSET
- CHROME VANADIUM STEEL
- DULY HARDENED AND TEMPERED



**ELLIPTICAL
PATTERN**

NICKEL CHROME PLATED

SIZES		LENGTH mm	WEIGHT gms (Approx.)
mm	SAE		
6	1/4	96	19
7		100	23
8	5/16	108	28
9		120	30
10	3/8	135	40
11	7/16	145	50
12		155	60
13	1/2	170	75
14	9/16	180	95
15		195	110
16	5/8	200	125
17	11/16	215	150
18		231	150
19	3/4	244	165
20		254	185
21	13/16	271	210
22	7/8	282	250
23		282	285
24	15/16	307	310
25	1	335	355
26		335	420
27	1.1/16	347	450
28	1.1/8	360	455
29		360	525
30		386	620
32	1.1/4	409	680

CODE	SETS IN MM	WEIGHT gms (Approx.)
60 M	8, 10, 12, 13, 14, 17	445
80 M	8, 9, 10, 11, 13, 14, 17, 19	650
110 M	6, 7, 8, 9, 10, 11, 12, 13, 14, 17, 19	750
120M	6, 7, 8, 9, 10, 11, 12, 13, 14, 17, 19, 22	1030
140M	6, 7, 8, 9, 10, 11, 12, 13, 14, 15, 17, 18, 19, 22	1305
250M	6, 7, 8, 9, 10, 11, 12, 13, 14, 15, 16, 17, 18, 19, 20, 21, 22, 23, 24, 25, 26, 27, 28, 30, 32	5695

Also available in SAE Sizes



NOTE :
Finish to Order : Full Polished / Satin
Packing to Order : Bulk or Individual Carton or Clip or Pouch/Wallet/Skin/Shrink/ Blister/ Window box.

**TORQUE MEETS AND EXCEEDS
DIN STANDARD.**

SEE PACKING ON PAGE NO. 23-27



Premium Hand Tools

SS-2101

DOUBLE OPEN END SPANNERS (DROP FORGED)

- RECESSED PANEL
- HEAD SET AT 15° ANGLE
- CARBON / CHROME VANADIUM STEEL
- DULY HARDENED AND TEMPERED



NICKEL CHROME PLATED (MATT FINISH)

SIZES		LENGTH mm	WEIGHT gms (Approx.)
mm	SAE		
6 X 7	1/4 X 5/16	85	18
8 X 9	5/16 X 11/32	102	25
	5/16 X 3/8	102	20
8 X 10		102	20
10 X 11	3/8 X 7/16	112	30
10 X 13		120	35
12 X 13	7/16 X 1/2	129	55
14 X 15	1/2 X 9/16	148	65
13 X 17		158	85
14 X 17	9/16 X 5/8	160	90
16 X 17	19/32 X 11/16	160	90
17 X 19	5/8 X 3/4	182	105
18 X 19		182	105
19 X 22	3/4 X 7/8	200	165
20 X 22	25/32 X 7/8	200	165
21 X 23		200	210
22 X 24	7/8 X 15/16	212	210
24 X 26	15/16 X 1	225	215
24 X 27		225	215
25 X 28	1 X 1.1/8	236	260
27 X 32	1.1/16 X 1.1/4	250	320
30 X 32	1.1/8 X 1.1/4	250	320

CODE	SETS IN SAE	WEIGHT gms (Approx.)
50 S	1/4X5/16, 3/8X7/16, 1/2X9/16, 19/32X11/16, 5/8X3/4	305
51 S	5/16X11/32, 3/8X7/16, 1/2X9/16, 19/32X11/16, 5/8X3/4	310
60 S	1/4X5/16, 3/8X7/16, 1/2X9/16, 19/32X11/16, 5/8X3/4, 25/32X7/8	450
61 S	5/16X11/32, 3/8X7/16, 1/2X9/16, 19/32X11/16, 5/8X3/4, 25/32X7/8	455

SETS IN MM		
60 M	6X7, 8X9, 10X11, 14X15, 16X17, 18X19	325
61 M	6X7, 8X9, 10X11, 12X13, 14X15, 16X17	275
62 M	8X9, 10X11, 12X13, 14X15, 16X17, 18X19	355
70 M	6X7, 8X9, 10X11, 12X13, 14X15, 16X17, 18X19	370
80 M	6X7, 8X9, 10X11, 12X13, 14X15, 16X17, 18X19, 20X22	545
100 M	6X7, 8X9, 10X11, 12X13, 14X15, 16X17, 18X19, 20X22, 21X23, 24X27	958
101 M	6X7, 8X9, 10X11, 12X13, 14X15, 16X17, 18X19, 20X22, 24X27, 30X32	1065
120 M	6X7, 8X9, 10X11, 12X13, 14X15, 16X17, 18X19, 20X22, 21X23, 24X26, 25X28, 27X32	1550
121 M	6X7, 8X9, 10X11, 12X13, 14X15, 16X17, 18X19, 20X22, 21X23, 24X27, 25X28, 30X32	1545

NOTE :
Finish to Order : Head / Matt Polished
Packing to Order : Bulk or Individual Carton or Clip or Pouch/Wallet/Skin/Shrink/ Blister/ Window box.

**TORQUE MEETS AND EXCEEDS
 IS:2028 STANDARD.**

SEE PACKING ON PAGE NO. 23-27



SS-2102

DOUBLE OPEN END SPANNERS-DIN 3110 (Long Pattern)

- RECESSED PANEL
- HEAD SET AT 15° ANGLE
- CHROME VANADIUM STEEL
- DULY HARDENED AND TEMPERED



NICKEL CHROME PLATED (MATT FINISH)

SIZES mm	LENGTH mm	WEIGHT gms (Approx.)
6 X 7	122	23
8 X 9	140	32
	140	45
10 X 11	157	50
12 X 13	172	62
14 X 15	190	80
14 X 17	190	110
16 X 17	205	110
17 X 19	222	150
18 X 19	222	150
19 X 22	236	200
20 X 22	236	200
	236	200
21 X 23	250	230
22 X 24	250	250
24 X 26	265	275
24 X 27	265	275
25 X 28	280	345
27 X 32	300	450
30 X 32	302	450

CODE	SETS IN MM	WEIGHT gms (Approx.)
60 M	6X7, 8X9, 10X11, 12X13, 14X15, 16X17	360
61 M	6X7, 8X9, 10X11, 14X15, 16X17, 18X19	420
62 M	8X9, 10X11, 12X13, 14X15, 16X17, 18X19	465
70 M	6X7, 8X9, 10X11, 12X13, 14X15, 16X17, 18X19	485
80 M	6X7, 8X9, 10X11, 12X13, 14X15, 16X17, 18X19, 20X22	685
100 M	6X7, 8X9, 10X11, 12X13, 14X15, 16X17, 18X19, 20X22, 21X23, 24X27	1120
101 M	6X7, 8X9, 10X11, 12X13, 14X15, 16X17, 18X19, 20X22, 24X27, 30X32	1405
120 M	6X7, 8X9, 10X11, 12X13, 14X15, 16X17, 18X19, 20X22, 21X23, 24X26, 25X28, 27X32	1955
121 M	6X7, 8X9, 10X11, 12X13, 14X15, 16X17, 18X19, 20X22, 21X23, 24X27, 25X28, 30X32	1955

NOTE :
Finish to Order : Head / Matt Polished
Packing to Order : Bulk or Individual Carton or Clip or Pouch/Wallet/Skin/Shrink/ Blister/ Window box.

**TORQUE MEETS AND EXCEEDS
DIN STANDARD.**

SEE PACKING ON PAGE NO. 23-27



Premium Hand Tools

SS-2104

DOUBLE OPEN END SPANNERS

- PRESS PANEL
- HEAD SET AT 15° ANGLE
- CHROME VANADIUM STEEL
- DULY HARDENED AND TEMPERED
- CONFIRMS TO **DIN-3110**



**COLD COINED
& STAMPED**

NICKEL CHROME PLATED

SIZES mm	LENGTH mm	WEIGHT gms (Approx.)
6 X 7	122	24
8 X 9	140	36
8 X 10	140	36
10 X 11	157	56
12 X 13	172	70
13 X 17	205	121
14 X 15	190	99
16 X 17	205	121
17 X 19	222	142
18 X 19	222	142
19 X 22	236	195
20 X 22	236	195
21 X 23	250	253
22 X 24	250	300
24 X 26	265	328
24 X 27	265	328
25 X 28	280	376
30 X 32	302	413

CODE	SETS IN MM	WEIGHT gms (Approx.)
60 M	6X7, 8X9, 10X11, 14X15, 16X17, 18X19	478
61 M	6X7, 8X9, 10X11, 12X13, 14X15, 16X17	406
62 M	8X9, 10X11, 12X13, 14X15, 16X17, 18X19	524
70 M	6X7, 8X9, 10X11, 12X13, 14X15, 16X17, 18X19	548
80 M	6X7, 8X9, 10X11, 12X13, 14X15, 16X17, 18X19, 20X22	743
100 M	6X7, 8X9, 10X11, 12X13, 14X15, 16X17, 18X19, 20X22, 21X23, 24X27	1359
101 M	6X7, 8X9, 10X11, 12X13, 14X15, 16X17, 18X19, 20X22, 24X27, 30X32	1485
121 M	6X7, 8X9, 10X11, 12X13, 14X15, 16X17, 18X19, 20X22, 21X23, 24X27, 25X28, 30X32	2204

NOTE :

Finish to Order : Head Polished / Satin / Matt
Packing to Order : Bulk or Individual Carton or Clip or Pouch/Wallet/Skin/Shrink/ Blister/ Window box.

**TORQUE MEETS AND EXCEEDS
DIN STANDARD.**

SEE PACKING ON PAGE NO. 23-27



SS-2105

DOUBLE OPEN END SPANNERS (Elliptical Pattern)

- HEAD SET AT 15° ANGLE
- CHROME VANADIUM STEEL
- DULY HARDENED AND TEMPERED
- EQUAL TO **DIN-3110**



NICKEL CHROME PLATED

SIZES mm	LENGTH mm	WEIGHT gms (Approx.)
6 X 7	122	24
8 X 9	140	36
8 X 10	140	36
10 X 11	157	56
12 X 13	172	70
13 X 17	205	121
14 X 15	190	99
16 X 17	205	121
17 X 19	222	142
18 X 19	222	142
19 X 22	236	195
20 X 22	236	195
21 X 23	250	253
22 X 24	250	300
24 X 26	265	328
24 X 27	265	328
25 X 28	280	376
30 X 32	302	413

CODE	SETS IN MM	WEIGHT gms (Approx.)
60 M	6X7, 8X9, 10X11, 14X15, 16X17, 18X19	478
61 M	6X7, 8X9, 10X11, 12X13, 14X15, 16X17	406
62 M	8X9, 10X11, 12X13, 14X15, 16X17, 18X19	524
70 M	6X7, 8X9, 10X11, 12X13, 14X15, 16X17, 18X19	548
80 M	6X7, 8X9, 10X11, 12X13, 14X15, 16X17, 18X19, 20X22	1324
100 M	6X7, 8X9, 10X11, 12X13, 14X15, 16X17, 18X19, 20X22, 21X23, 24X27	1485
101 M	6X7, 8X9, 10X11, 12X13, 14X15, 16X17, 18X19, 20X22, 24X27, 30X32	1604
121 M	6X7, 8X9, 10X11, 12X13, 14X15, 16X17, 18X19, 20X22, 21X23, 24X27, 25X28, 30X32	2204

Also available in SAE sizes

GOLD SATIN FINISH



BLACK SATIN FINISH



SATIN FINISH



NOTE :
Finish to Order : Fully Polished / Satin / Matt
Packing to Order : Bulk or Individual Carton or Clip or Pouch/Wallet/Skin/Shrink/ Blister/ Window box.

**TORQUE MEETS AND EXCEEDS
 DIN STANDARD.**

SEE PACKING ON PAGE NO. 23-27



Premium Hand Tools

SS-2201

BI-HEXAGON RING SPANNER

- DEEP OFFSET
- CHROME VANADIUM STEEL
- DULY HARDENED AND TEMPERED
- CONFIRMS TO **DIN-838**

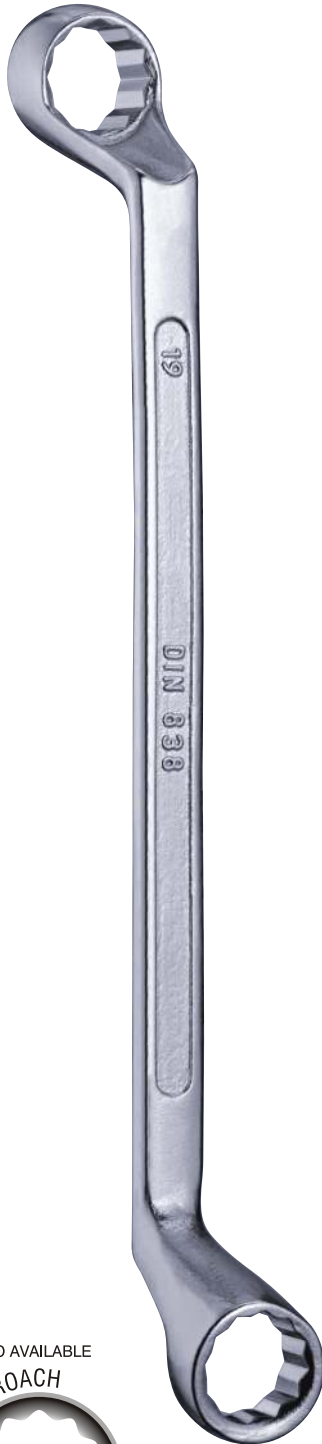

ALSO AVAILABLE

SUPER DRIVE BROACH



NICKEL CHROME PLATED

SIZES		LENGTH mm	WEIGHT gms (Approx.)
mm	SAE		
6 X 7	1/4 X 5/16	170	54
8 X 9	5/16 X 3/8	182	75
8 X 10		185	90
10 X 11	3/8 X 7/16	195	90
10 X 13		200	108
12 X 13		212	108
14 X 15	1/2 X 9/16	226	138
16 X 17	5/8 X 11/16	242	167
17 X 19		250	200
18 X 19	3/4 X 25/32	261	200
19 X 22	3/4 X 7/8	275	280
20 X 22	13/16 X 7/8	296	280
21 X 23		315	310
24 X 26	15/16 X 1	325	358
24 X 27		325	358
25 X 28	1 X 1.1/8	335	414
27 X 32	1.1/16 X 1.1/4	365	530
30 X 32		365	530

Special Sizes :

6x8, 9x11, 10x12,
13x14, 14x17, 18x21,
22x24, 27x30, 32x36,
36x41, 41x46mm

CODE	SETS IN MM	WEIGHT gms (Approx.)
60 M	6X7, 8X9, 10X11, 12X13, 14X15, 16X17	640
61 M	6X7, 8X9, 10X11, 14X15, 16X17, 18X19	733
80 M	6X7, 8X9, 10X11, 12X13, 14X15, 16X17, 18X19, 20X22	1150
100 M	6X7, 8X9, 10X11, 12X13, 14X15, 16X17, 18X19, 20X22, 24X26, 27X32	2105
120M	6X7, 8X9, 10X11, 12X13, 14X15, 16X17, 18X19, 20X22, 21X23, 24X26, 25X28, 27X32	2705
121M	6X7, 8X9, 10X11, 12X13, 14X15, 16X17, 18X19, 20X22, 21X23, 24X27, 25X28, 30X32	2725

NOTE :

Finish to Order : Ring Polished / Satin
Packing to Order : Bulk or Individual Carton or Clip or
Pouch/Wallet/Skin/Shrink/ Blister/ Window box.

TORQUE MEETS AND EXCEEDS
DIN STANDARD.

SEE PACKING ON PAGE NO. 23-27



SS-2202

BI-HEXAGON RING SPANNER

- PRESS PANEL
- DEEP OFFSET
- CHROME VANADIUM STEEL
- DULY HARDENED AND TEMPERED
- CONFIRMS TO **DIN-838**



**COLD COINED
& STAMPED**

NICKEL CHROME PLATED

SIZES mm	LENGTH mm	WEIGHT gms (Approx.)
6 X 7	180	50
8 X 9	192	70
10 X 11	210	90
12 X 13	220	107
14 X 15	230	135
16 X 17	250	160
18 X 19	268	204
20 X 22	295	270
21 X 23	325	289
24 X 27	330	365
25 X 28	340	442
30 X 32	365	560

CODE	SETS IN MM	WEIGHT gms (Approx.)
60 M	6X7, 8X9, 10X11, 12X13, 14X15, 16X17	615
61 M	6X7, 8X9, 10X11, 14X15, 16X17, 18X19	709
80 M	6X7, 8X9, 10X11, 12X13, 14X15, 16X17, 18X19, 20X22	1085
121M	6X7, 8X9, 10X11, 12X13, 14X15, 16X17, 18X19, 20X22, 21X23, 24X27, 25X28, 30X32	2775

NOTE :
Finish to Order : Ring Polished / Satin / Matt
Packing to Order : Bulk or Individual Carton or Clip or
 Pouch/Wallet/Skin/Shrink/ Blister/ Window box.

**TORQUE MEETS AND EXCEEDS
DIN STANDARD.**

SEE PACKING ON PAGE NO. 23-27



Premium Hand Tools

SS-2203

BI-HEXAGON RING SPANNER (Elliptical Pattern)

- DEEP OFFSET
- CHROME VANADIUM STEEL
- DULY HARDENED AND TEMPERED
- CONFIRMS TO **DIN-838**



NICKEL CHROME PLATED

SIZES mm	LENGTH mm	WEIGHT gms (Approx.)
6 X 7	180	53
8 X 9	192	69
10 X 11	210	86
12 X 13	220	107
14 X 15	230	135
16 X 17	250	160
18 X 19	268	204
20 X 22	295	270
21 X 23	325	289
24 X 27	330	365
25 X 28	340	442
30 X 32	365	560

CODE	SETS IN MM	WEIGHT gms (Approx.)
60 M	6X7, 8X9, 10X11, 12X13, 14X15, 16X17	655
61 M	6X7, 8X9, 10X11, 14X15, 16X17, 18X19	740
80 M	6X7, 8X9, 10X11, 12X13, 14X15, 16X17, 18X19, 20X22	1170
121M	6X7, 8X9, 10X11, 12X13, 14X15, 16X17, 18X19, 20X22, 21X23, 24X27, 25X28, 30X32	2875

NOTE :
Finish to Order : Fully Polished / Satin / Matt
Packing to Order : Bulk or Individual Carton or Clip or Pouch/Wallet/Skin/Shrink/ Blister/ Window box.

**TORQUE MEETS AND EXCEEDS
 DIN STANDARD.**

SEE PACKING ON PAGE NO. 23-27



SS-2204

BI-HEXAGON RING SPANNER (Recess Panel)

- SHALLOW OFFSET
- CHROME VANADIUM STEEL
- DULY HARDENED AND TEMPERED
- CONFIRMS TO **DIN-897**



NICKEL CHROME PLATED

SIZES mm	LENGTH mm	WEIGHT gms (Approx.)
6 X 7	180	50
8 X 9	192	70
10 X 11	210	90
12 X 13	220	105
14 X 15	230	135
16 X 17	250	165
18 X 19	268	195
20 X 22	295	275
21 X 23	325	305
24 X 27	330	348
25 X 28	340	405
30 X 32	365	520

CODE	SETS IN MM	WEIGHT gms (Approx.)
60 M	6X7, 8X9, 10X11, 12X13, 14X15, 16X17	622
61 M	6X7, 8X9, 10X11, 14X15, 16X17, 18X19	715
80 M	6X7, 8X9, 10X11, 12X13, 14X15, 16X17, 18X19, 20X22	1090
121M	6X7, 8X9, 10X11, 12X13, 14X15, 16X17, 18X19, 20X22, 21X23, 24X27, 25X28, 30X32	2675

ALSO AVAILABLE



CONVENTIONAL BROACH

NOTE :
Finish to Order : Ring Polished / Satin
Packing to Order : Bulk or Individual Carton or Clip or Pouch/Wallet/Skin/Shrink/ Blister/ Window box.

**TORQUE MEETS AND EXCEEDS
 DIN STANDARD.**

SEE PACKING ON PAGE NO. 23-27



Premium Hand Tools

SS-2059

OBSTRUCTION S-TYPE WRENCH COMBINATION

- ELLIPTICAL PATTERN
- CHROME VANADIUM STEEL
- DULY HARDENED AND TEMPERED



SIZE mm	LENGTH mm
10	100
11	100
12	100
13	100
14	100
15	100
17	60
19	60
22	60

NO. OF PCS./SET	SIZE mm	QTY./CTN. pcs.
6	10, 12, 13, 14, 17, 19	20 Set
8	10, 11, 12, 13, 14, 17, 19, 22	20 Set

SS-2060

OBSTRUCTION S-TYPE WRENCH RING

- ELLIPTICAL PATTERN
- CHROME VANADIUM STEEL
- DULY HARDENED AND TEMPERED

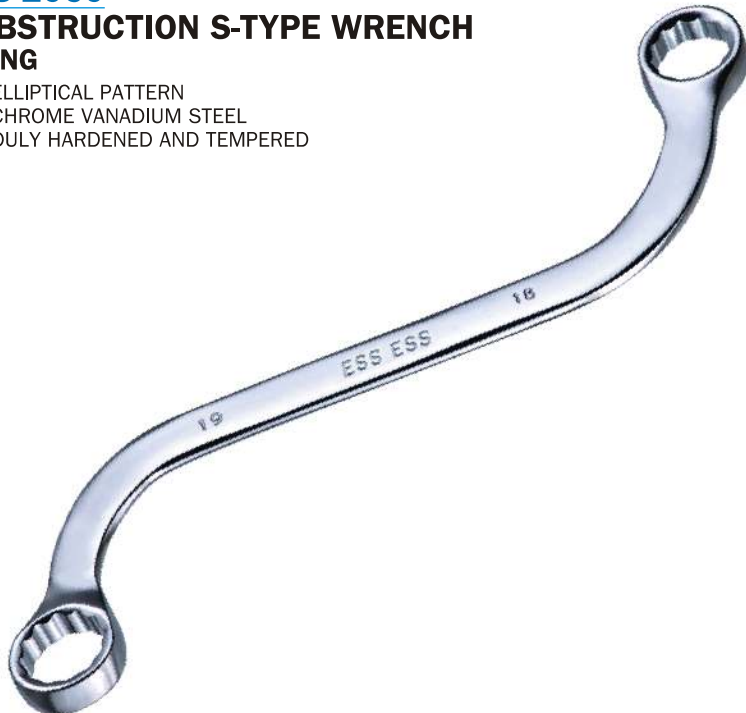

SIZE mm	SIZE SAE
10 x 11	3/8" x 13/32"
12 x 13	7/16" x 1/2"
14 x 15	9/16" x 19/32"
16 x 17	5/8" x 11/16"
18 x 19	11/16" x 3/4"
20 x 22	13/16" x 7/8"

NO. OF PCS./SET	SIZE mm	QTY./CTN. pcs.
5	10x11, 12x13, 14x15, 16x17, 18x19	20 Set
6	10x11, 12x13, 14x15, 16x17, 18x19, 20x22	20 Set
10	10x11, 12x13, 14x15, 16x17, 18x19 3/8" x 13/32", 7/16" x 1/2" 9/16" x 19/32", 5/8" x 11/16" 11/16" x 3/4"	10 Set

NOTE :
Finish to Order : Fully Polished / Satin / Matt
Packing to Order : Bulk or Individual Carton or Clip or Pouch/Wallet/Skin/Shrink/ Blister/ Window box.

TORQUE MEETS AND EXCEEDS INTERNATIONAL STANDARD.

SEE PACKING ON PAGE NO. 23-27



SS-2061

OBSTRUCTION HALF MOON WRENCH COMBINATION

- ELLIPTICAL PATTERN
- CHROME VANADIUM STEEL
- DULY HARDENED AND TEMPERED



SIZE mm	LENGTH mm
10	100
11	100
12	100
13	100
14	100
15	100
17	60
19	60
22	60

NO. OF PCS./SET	SIZE mm	QTY./CTN. pcs.
6	10, 12, 13, 14, 17, 19	20 Set
8	10, 11, 12, 13, 14, 17, 19, 22	20 Set

SS-2062

OBSTRUCTION HALF MOON WRENCH RING

- ELLIPTICAL PATTERN
- CHROME VANADIUM STEEL
- DULY HARDENED AND TEMPERED



SIZE mm	SIZE SAE
8 x 10	5/16" x 3/8"
10 x 11	
11 x 13	7/16" x 1/2"
12 x 13	
14 x 15	9/16" x 5/8"
16 x 17	
17 x 19	11/16" x 3/4"
18 x 19	
21 x 22	13/16" x 7/8"

NO. OF PCS./SET	SIZE mm	QTY./CTN. pcs.
5	8x10, 11x13, 14x15, 17x19, 21x22	20 Set
6	8x10, 10x11, 12x13, 14x15, 16x17, 18x19	20 Set
10	8x10, 11x13, 14x15, 17x19, 21x22 5/16" x 3/8", 7/16" x 1/2" 9/16" x 5/8", 11/16" x 3/4" 13/16" x 7/8"	10 Set

NOTE :
Finish to Order : Fully Polished / Satin / Matt
Packing to Order : Bulk or Individual Carton or Clip or Pouch/Wallet/Skin/Shrink/ Blister/ Window box.

TORQUE MEETS AND EXCEEDS INTERNATIONAL STANDARD.

SEE PACKING ON PAGE NO. 23-27



Premium Hand Tools

SS-2056

FLARE NUT WRENCH

- ELLIPTICAL PATTERN
- CHROME VANADIUM STEEL
- DULY HARDENED AND TEMPERED
- CONFIRMS TO **DIN-3118**



HEX

SIZE mm	LENGTH mm	QTY./CTN. pcs.
8 x 10	140	300
9 x 11	150	250
10 x 11	150	250
10 x 12	150	250
12 x 14	170	200
13 x 14	200	200

BI-HEX

SIZE mm	LENGTH mm	QTY./CTN. pcs.
14 x 17	200	100
17 x 19	210	100
19 x 22	220	75
22 x 24	235	60
24 x 27	255	60
30 x 32	280	40

SS-2057

TORX DOUBLE ENDED RING WRENCH

- ELLIPTICAL PATTERN
- CHROME VANADIUM STEEL
- DULY HARDENED AND TEMPERED



SIZE mm	QTY./CTN. pcs.
E6 x E8	100
E10 x E12	100
E14 x E18	100
E20 x E24	100

NO. OF PCS./SET	SIZE mm	QTY./CTN. pcs.
4	E6xE8, E10xE12, E14xE18, E20 x E24	25 Set

SS-2058

STUBBY WRENCH

- ELLIPTICAL PATTERN
- CHROME VANADIUM STEEL
- DULY HARDENED AND TEMPERED

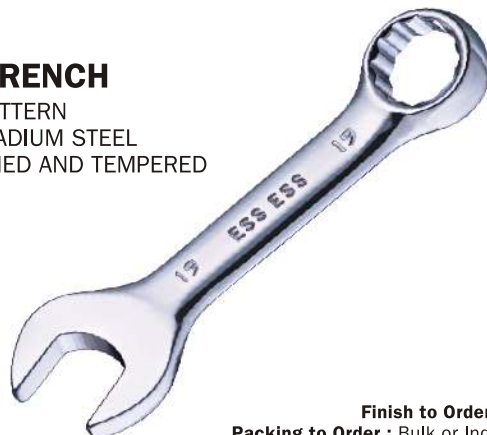

SIZE mm	SIZE SAE
10mm to 19mm	3/8 to 3/4

NOTE :
Finish to Order : Fully Polished / Satin
Packing to Order : Bulk or Individual Carton or Clip or Pouch/Wallet/Skin/Shrink/ Blister/ Window box.

TORQUE MEETS AND EXCEEDS INTERNATIONAL STANDARD.

SEE PACKING ON PAGE NO. 23-27



PACKAGING

SS-1



SS-2



SS-3



SS-4



SS-5



SS-31



SS-7



SS-8



SS-9



SS-10



SS-11





Premium Hand Tools

PACKAGING

SS-30



SS-32



SS-33



SS-34



SS-36



SS-37



SS-35



SS-16



SS-17



SS-18



SS-19



SS-24



SS-25



SS-20



SS-21



SS-22





PACKAGING





Premium Hand Tools

PACKAGING

SS-40



SS-41



SS-42



SS-43



SS-44



SS-45



SS-46



SS-47



SS-48





PACKAGING

SS-26



SS-27



SS-28



SS-14



SS-29



SS-15



SS-12





Premium Hand Tools

SS-2063

TRUCK WHEEL SPANNER

- DROP FORGED
- SELECTED STEEL
- FULLY HARDENED & TEMPERED
- MADE TO PROFESSIONAL ACCURACY
- **TOMMY BAR OPTIONAL**



MM	INCHES	LENGTH mm
24x27	-	400
27x30	1 5/16x1	400
27x32	-	400
27x33	1 x 1 1/4	400
30x32	-	400
33x33	1.1 / 4 x 1 1/4	400
38x21	1.1 / 2 x 1 3/16	400
41x21	1.3 / 4 x 1 3/16	400

To Order :

Chrome Plated / Powder Coated / Zinc Plated

SS-2064

CROSS WHEEL RIM SPANNER (RE-INFORCED)

Dia & Length to order
13mm x 13"
13mm x 13.5"
14mm x 14"



MM & SAE	LENGTH inches	DIA MM
17x19x21x1/2	14 & 16	16
17x19x21x23	14 & 16	16

Finish to Order

SS-2065

CROSS WHEEL RIM SPANNER (NORMAL)

Dia & Length to order
13mm x 13"
13mm x 13.5"
14mm x 14"



MM & SAE	LENGTH inches	DIA MM
17x19x21x22	13/14/16/18/20	13/14/15/16/18
17x19x21x23	13/14/16/18/20	13/14/15/16/18
17x19x13/16x22	13/14/16/18/20	13/14/15/16/18
17x19x21x1/2	13/14/16/18/20	13/14/15/16/18

Finish to Order

To Order :

Chrome Plated / Powder Coated / Zinc Plated



SS-2066

L-SPANNER

TO ORDER :

- (a) With Tyre Lever
- (b) Without Tyre Lever
- (c) With Jack Rod

- Chrome Finish/Powder Coated
- Silver Painted/Zinc Plated
- Black Zinc Plated

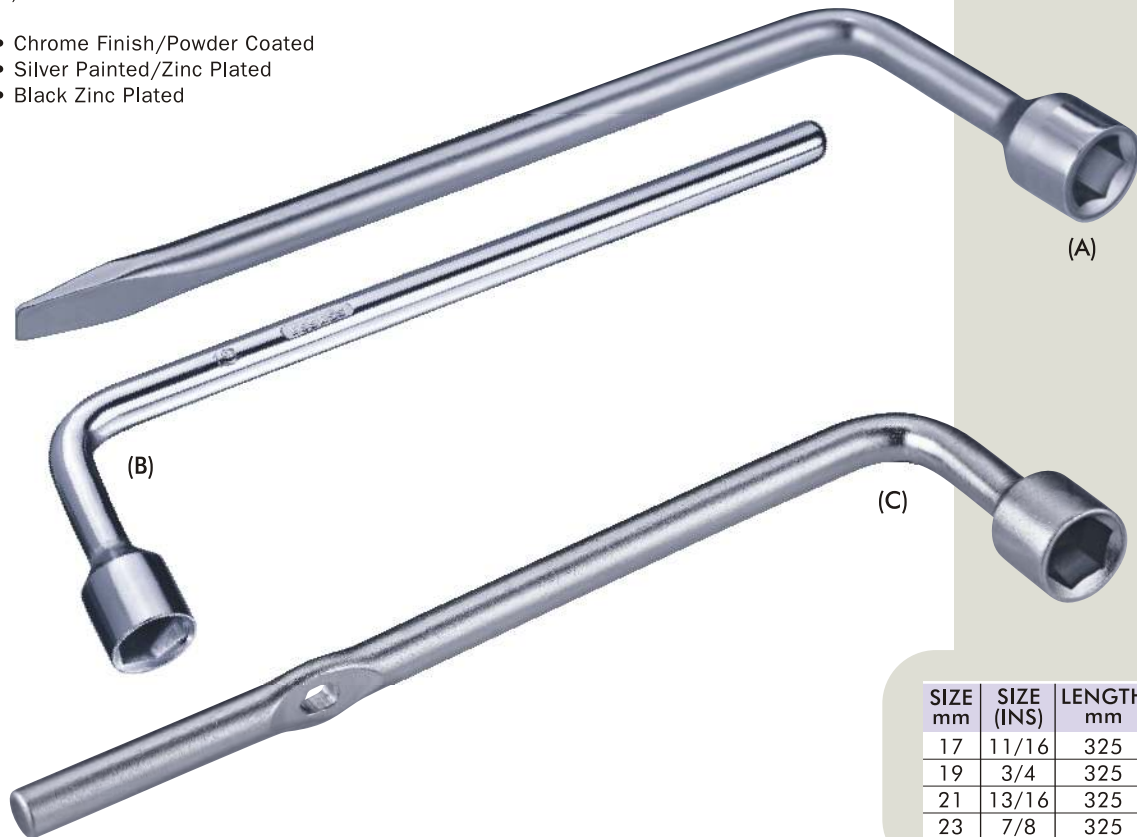

SIZE mm	SIZE (INS)	LENGTH mm
17	11/16	325
19	3/4	325
21	13/16	325
23	7/8	325

SS-2068

T - SOCKET SPANNERS

- DROP FORGED
- SPECIAL CARBON STEEL



SOCKET SIZE		LENGTH
mm	SAE	inch
6	1/4	8
7		8
8	3/16	10
9		10
10	3/8	10
11	7/16	10
12		10
13	1/2	10
14	9/16	10
15		10
16	5/8	10
17	11/16	10
18		10
19	3/4	10

To Order :

Chrome Plated / Powder Coated / Zinc Plated



Premium Hand Tools

SS-2069

BOX SPANNER TOMMY BAR (Optional)

- ZINC PLATED
- SHOT BLAST



MM	INCHES	LENGTH mm
6x7	1/4x5/16	110
8x9	5/16x11/32	110
10x11	3/8x7/16	125
12x13	7/16x1/2	135
14x15	1/2x9/16	140
16x17	14/32x11/16	150
18x19	5/8x3/4	165
20x22	13/16x7/8	170
21x23	-	170
24x26	15/16x1	190
25x28	1x1.1/8	200
30x32	1.1/16x1.14	215
32x36	-	215
36x41	-	215
41x46	-	215
46x50	-	230
50x55	-	230

SET OF 8 PCS.
SET OF 12 PCS.

SS-2070

SPARK PLUG SPANNER

- ZINC PLATED

SIZE : 21mm / TO ORDER

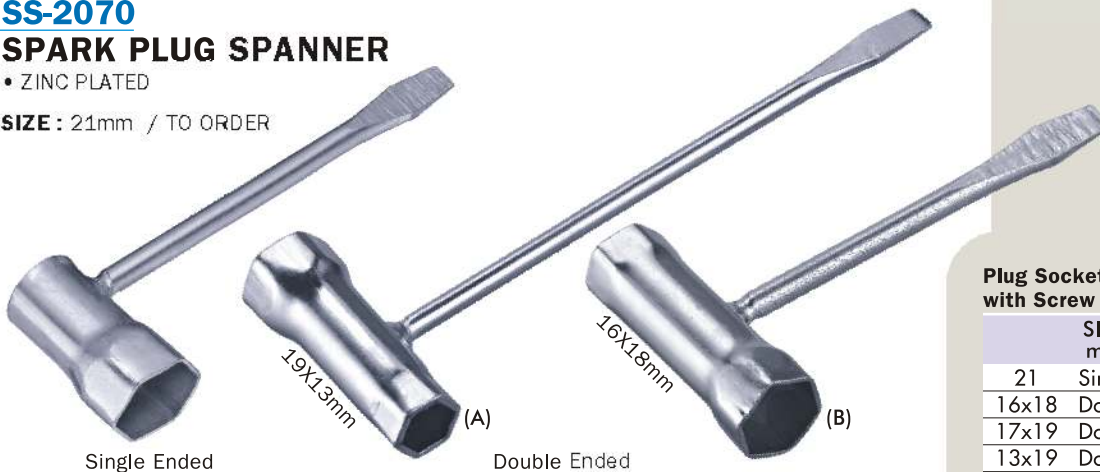

Single Ended

Double Ended

Plug Socket with Screw Driver

SIZE mm	
21	Single Ended
16x18	Double Ended
17x19	Double Ended
13x19	Double Ended
16x21	Double Ended

SS-2071

PLUG SPANNER SWIVEL HEAD

SIZE : 21mm Socket
Length : 101mm



with Handle & Rubber inner

SIZE mm	
16x101	21x101
16x160	21x160
16x230	21x230
16x270	21x270
	21x290



SS-2072
SINGLE ENDED
SOCKET WRENCHES
 • ZINC PLATED

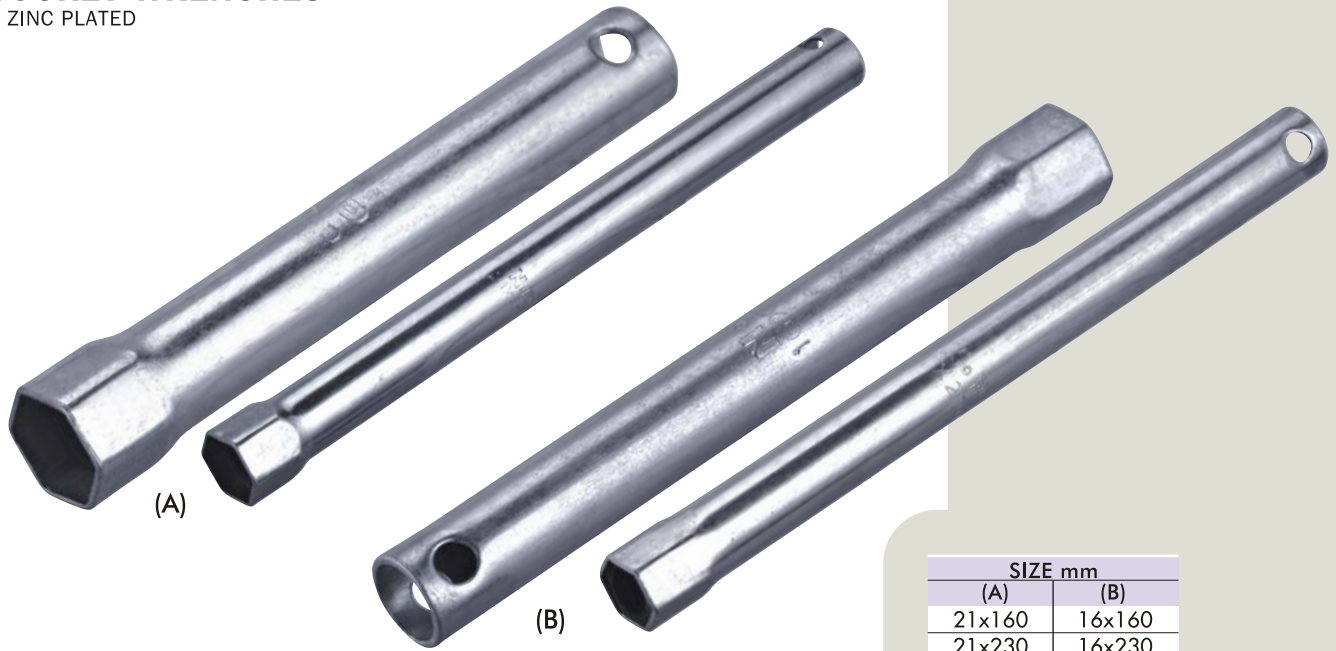

SIZE mm	
(A)	(B)
21x160	16x160
21x230	16x230
21x270	16x270
21x290	

SS-2073
ALLEN KEY SET
 Hard & Temper



SIZE mm	
1.5	6
2	8
2.5	10
3	12
4	14
5	17
5.5	19

Also Available
 SAE/Inches Sizes

SS-2375
BEARING PULLER



TO ORDER :
 Chrome Plated Screw /Black Screw
 also available with 2 holes for extension

SIZE	
mm	inches
75	3
100	4
150	6
200	8
250	10
300	12



Premium Hand Tools

SS-2090

PIPE WRENCH (STILLSON TYPE)

- DROP FORGED
- SELECTED STEEL
- SUITABLE HARDENED & TEMPERED JAWS

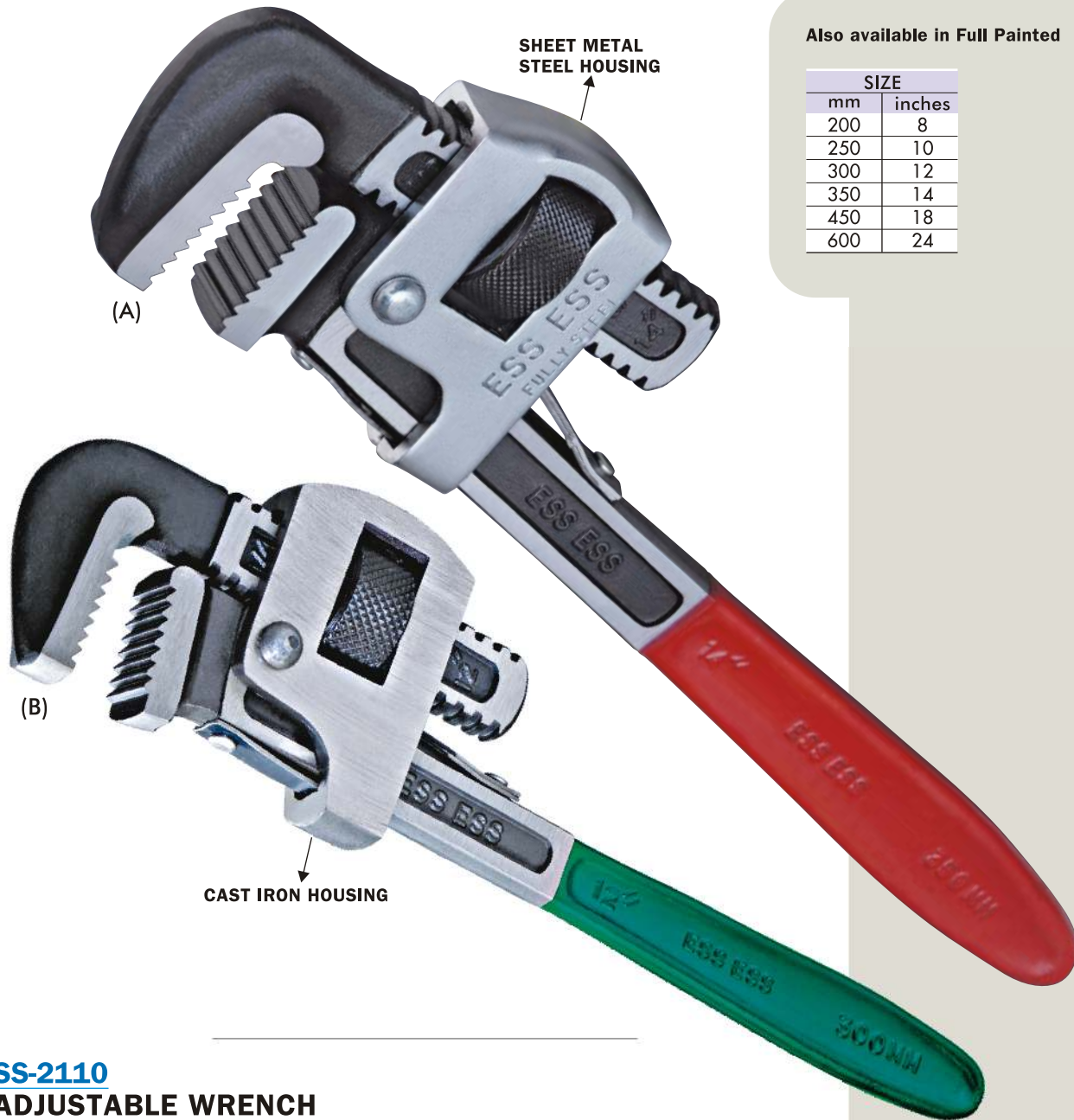

Also available in Full Painted

SIZE	
mm	inches
200	8
250	10
300	12
350	14
450	18
600	24

SS-2110

ADJUSTABLE WRENCH

- DROP FORGED
- SELECTED STEEL / CHROME VANADIUM STEEL



• BLACK PHOSPHATE/BCP

SIZE	
mm	inches
150	6
200	8
250	10
300	12



SS-2115

CHAIN PIPE WRENCH

- DROP FORGED
- SELECTED CARBON STEEL
- STEEL JAWS & FRAME LONGER HANDLE FOR COMFORTABLE WORKING



TO ORDER :

Colour : Blue / Black / Red

SIZE	
mm	inches
50	2
75	3
100	4
150	6
200	8
250	10
300	12

SS-2120

**OIL FILTER WRENCH
(HEAVY DUTY WITH PLASTIC GRIP)**

- SELECTED CARBON STEEL
- CHAIN TYPE ADJUSTABLE
- FIRM GRIP LOOPS HARDENED & TEMPERED



SS-2125

**OIL FILTER WRENCH
(LIGHT & HEAVY DUTY)**



SS-2130

**SPRING CLAMP SUSPENSION
COIL COMPRESSOR**



SIZE mm
16.90 x 160
16.90 x 230
16.90 x 280
16.90 x 320



Premium Hand Tools

SS-2151

COMBINATION PLIER

- DROP FORGED
- SELECTED CARBON STEEL / CHROME VANADIUM STEEL
- HARDENED & TEMPERED



SIZE	
mm	inches
150	6
175	7
200	8

SS-2152

LONG NOSE PLIER

- DROP FORGED
- SELECTED CARBON STEEL / CHROME VANADIUM STEEL
- HARDENED & TEMPERED JAWS
- DIAGONALLY OPPOSED ENABLES GRIPPING OF THINNEST WIRES & COMPONENTS.



TO ORDER :

- (a) Chrome Plated
- (b) Burnished

SIZE	
mm	inches
150	6
175	7
200	8

SS-2153

DIAGONAL CUTTING PLIER

- DROP FORGED STEEL
- SELECTED CARBON STEEL / CHROME VANADIUM STEEL
- INDUCTION HARDENED JAWS



TO ORDER :

- (a) Chrome Plated
- (b) Burnished

SIZE	
mm	inches
150	6
175	7
200	8



SS-2175

**WATER PUMP PLIER
(GROOVE JOINT TYPE)**

- DROP FORGED
- SELECTED CARBON STEEL
- INDUCTION HARDENED JAWS & RIBBED HANDLES FOR SLIP FREE GRIPPING



TO ORDER :

- with or without sleeve

SIZE	
mm	inches
150	6
200	8
250	10
300	12
400	16

SS-2177

**WATER PUMP PLIER
(BOX TYPE)**

- DROP FORGED
- SELECTED CARBON STEEL / CHROME VANADIUM STEEL
- INDUCTION HARDENED JAWS & RIBBED HANDLES FOR SLIP FREE GRIPPING



TO ORDER :

- with sleeve or without sleeve

FINISH :

- Painted / Powder Coated
- Polished

SIZE	
mm	inches
250	10
300	12

SS-2178

**WATER PUMP PLIER
(SLIP JOINT)**

- DROP FORGED
- SELECTED CARBON STEEL
- INDUCTION HARDENED JAWS & RIBBED HANDLES FOR SLIP FREE GRIPPING



TO ORDER :

- with sleeve or without sleeve

FINISH :

- Chrome Plated
- Powder Coated

SIZE	
mm	inches
250	10

SS-2180

SLIP JOINT PLIER

- DROP FORGED
- SELECTED CARBON STEEL
- HARDENED & TEMPERED JAWS



TO ORDER :

- with or without sleeve

Finish : Matt or Polished

SIZE	
mm	inches
150	6
200	8



Premium Hand Tools

SS-2201

LOCKING PLIER

- DROP FORGED
- SELECTED CARBON STEEL
- INDUCTION HARDENED & TEMPERED JAWS



FINISH :

- Chrome Plated

SIZE	
mm	inches
125	5
175	7
250	10

SS-2210

TOWER PINCER

- DROP FORGED
- SELECTED CARBON STEEL
- INDUCTION HARDENED & TEMPERED JAWS



TO ORDER :

- with or without PVC Dip Sleeve

SIZE	
mm	inches
200	8
225	9
250	10
300	12

SS-2213

CARPENTER / COBBLER PINCER

- DROP FORGED
- SELECTED CARBON STEEL
- INDUCTION HARDENED & TEMPERED JAWS



TO ORDER :

- with or without PVC Dip Sleeve / Double Dip Sleeve

SIZE	
mm	inches
150	6
175	7
200	8
250	10

SS-2214

TOP CUTTER

- DROP FORGED
- SELECTED CARBON STEEL
- INDUCTION HARDENED & TEMPERED JAWS



TO ORDER :

- with or without PVC Dip sleeve

SIZE	
mm	inches
150	6
175	7
200	8



SS-2231

WRECKING BAR

- SELECTED CARBON STEEL
- HARDENED & TEMPERED

Colour : Black/Blue/Red

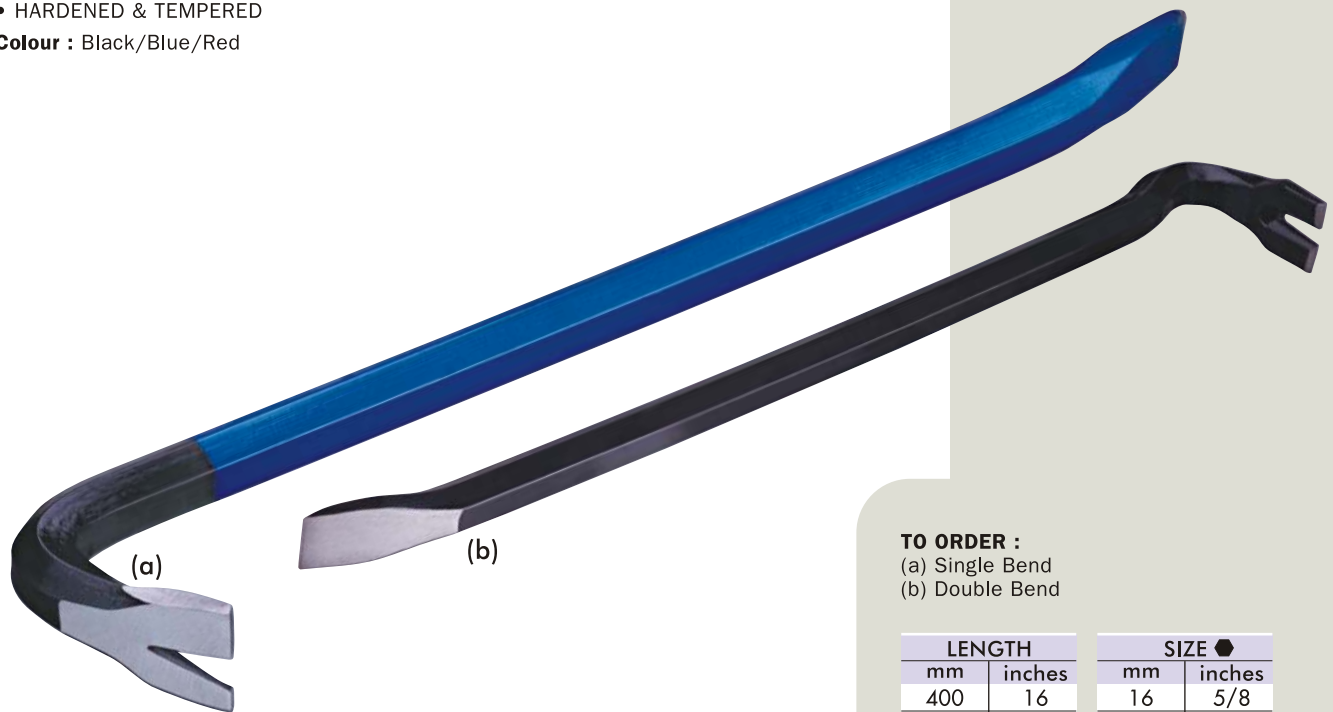

TO ORDER :
 (a) Single Bend
 (b) Double Bend

LENGTH		SIZE ●	
mm	inches	mm	inches
400	16	16	5/8
450	18	18	3/4
600	24	20	13/16
750	30		
900	36		

with Across Flat

SS-2245

CHISELS Flat & Pointed Octagonal

- SELECTED CARBON STEEL
- HARDENED & TEMPERED



TO ORDER :
 • Painted / Powder Coated
 • Any Colour
 • with or without Grip

SIZES :
 ● 1/4", 5/8, 3/4, 1"

SIZE	
mm	inches
150	6
200	8
250	10
300	12

SS-2246

FLAT CHISEL

- DROP FORGED
- SELECTED CARBON STEEL
- HARDENED & TEMPERED



TO ORDER :
 • Painted / Powder Coated
 • Any Colour
 • with or without Grip

SIZE	
mm	inches
150	6
200	8
250	10
300	12



Premium Hand Tools

SS-2265

**CLAW HAMMER
STEEL SHAFT WITH GRIP**



*ALSO AVAILABLE IN MALLEABLE STEEL

- DROP FORGED
- SELECTED CARBON STEEL
- HARDENED & TEMPERED
- STEEL SHAFT WITH AN IMPACT ABSORBING NON SLIP RUBBER GRIP

SIZE		
LBS	GMS	OZ
1/2	225	8
1	450	16

SS-2268

**CLAW HAMMER
WITH WOODEN HANDLE**



- DROP FORGED
- SELECTED CARBON STEEL
- HARDENED & TEMPERED
- SEASONED WOODEN HANDLE

TO ORDER :

- with or without handle

SIZE		
LBS	GMS	OZ
1/2	225	8
1	450	16

SS-2270

BALL PEIN HAMMER



- DROP FORGED
- SELECTED CARBON STEEL
- HARDENED & TEMPERED
- SEASONED WOODEN HANDLE

SIZE		
LBS	GMS	OZ
1/4	110	4
1/2	225	8
3/4	335	12
1	450	16
1-1/2	675	24
2	900	32
3	1350	48



SS-2272
MACHINIST HAMMER



- DROP FORGED
- SELECTED STEEL
- HARDENED & TEMPERED
- SEASONED WOODEN HANDLE

TO ORDER :
• with or without handle

SIZE GMS
100
200
300
400
500
800
1000

SS-2275
CLUB HAMMER



- DROP FORGED
- SELECTED STEEL
- HARDENED & TEMPERED
- SEASONED WOODEN HANDLE / STEEL & FIBRE HANDLE

TO ORDER :
• with or without handle

SIZE GMS
800
1000
1200
1500
2000
3000

SS-2278
SLEDGE HAMMER



- DROP FORGED
- SELECTED STEEL
- HARDENED & TEMPERED
- SEASONED WOODEN HANDLE / STEEL & FIBRE HANDLE

TO ORDER :
• with or without handle

SIZE GMS
800
1000
1200
1500
2000
3000
5000



SS-2285

GREASE GUN LEVER TYPE

• FOR LIGHT & MEDIUM DUTY GREASE



CAPACITY	PRESSURE	PISTON
15 OZ	8000 PSI	5/8"

Sizes available upto 20 oz

To order : Fix Hose/ Nylon Hose/ Rubber Hose
Available in any Colour

SS-2290

GREASE GUN MINI PUSH TYPE

Produces pressure upto 2000psi



SIZE CAPACITY
4 OZ
8 OZ
10 OZ



SS-2294

HIGH PRESSURE OIL CAN (WESCO TYPE)

- FORCED FEED PUMP
- MECHANISM SEAMLESS STEEL BODY
- DRAWN FROM E.D.D. C.R.C.A. SHEET
- RED / BLUE METTALLIC PAINT (OVEN BAKED)



TO ORDER :
Fixed or Flexible Spout

SIZE	
PINT	CC
1/4	125
1/2	250
3/4	375
1	500

SS-2296

HIGH DUTY OIL CAN (PERFETTO TYPE)

- FORCED FEED PUMP
- MECHANISM SEAMLESS STEEL BODY
- DRAWN FROM E.D.D. C.R.C.A. SHEET
- RED / BLUE METTALLIC PAINT (OVEN BAKED)



TO ORDER :
Fixed or Flexible Spout

SIZE	
CC	
125	
200	
300	
500	

SS-2298

OIL CAN (PISTOL TYPE)

- FORCED FEED PUMP
- MECHANISM SEAMLESS STEEL BODY
- DRAWN FROM E.D.D. C.R.C.A. SHEET
- RED / BLUE METTALLIC PAINT (OVEN BAKED)



TO ORDER :
Fixed or Flexible Spout

SIZE	
PINT	CC
1/4	125

SS-2300

ROTARY PUMP

- ERW PIPE ON SUCTION SIDE AND CHROME PLATED ON DELIVERY SIDE
- SIZE : (OUT LET CAPACITY)
(HEAVY DUTY) : 1-1/2"
(MEDIUM DUTY) : 1"
(LIGHT DUTY) : 3/4"



TO ORDER :
With or without Flexible outlet Hose (1 Meter Long)



Premium Hand Tools

SS-2342

IRON JACK PLANE

- FINEST IRON CASTING
- BOTTOM PERFECTLY MACHINED
- HIGH CARBON STEEL CUTTER (HARDENED AND TEMPERED)
- SEASONED WOODEN KNOB AND HANDLE

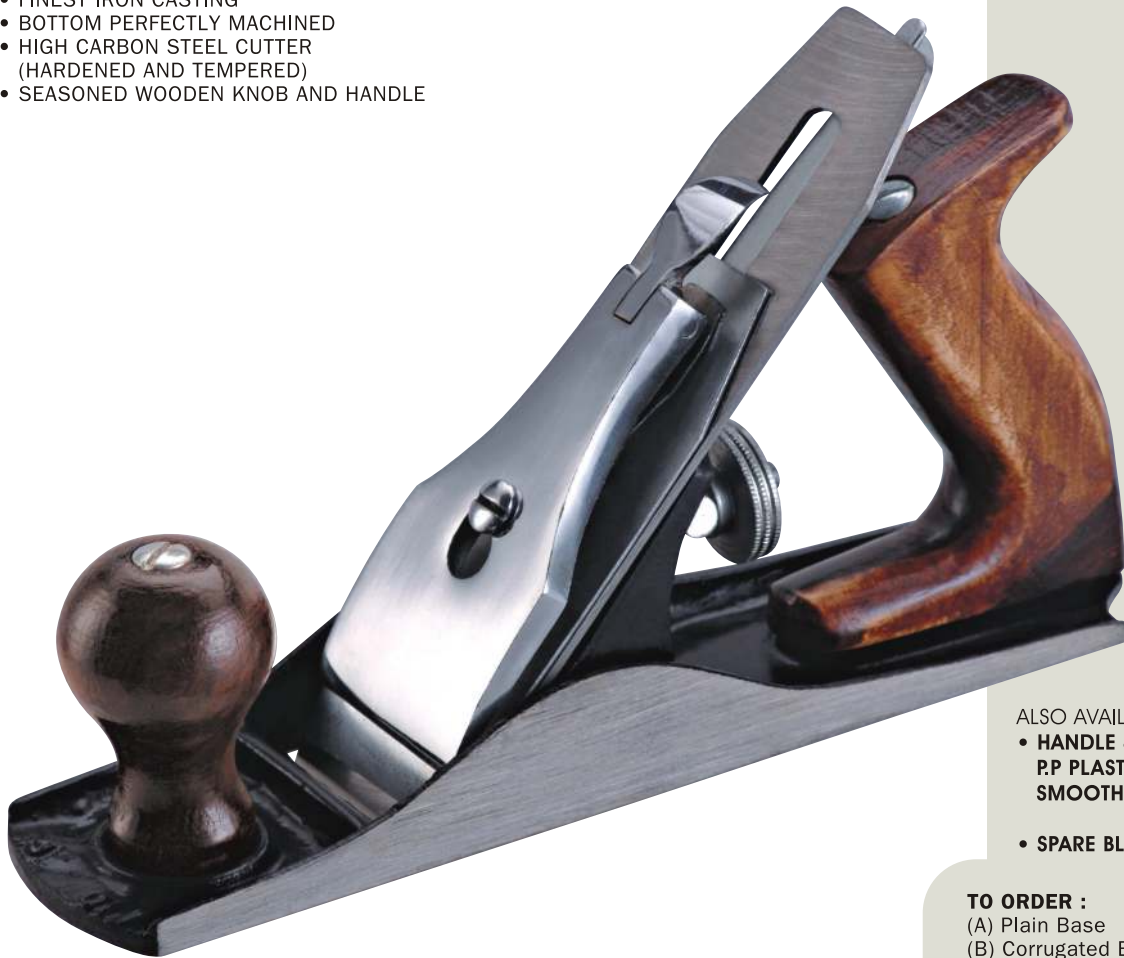

ALSO AVAILABLE :

- HANDLE & KNOB MADE OF P.P PLASTIC WITH SILKY SMOOTH FINISH

- SPARE BLADES

TO ORDER :

- (A) Plain Base
- (B) Corrugated Base

CORRUGATED BASE



SIZE	
No.	inches
3	8
4	9
5	14
6	18
7	20
8	24

SS-2345

BLOCK PLANE

- FINEST IRON CASTING
- BOTTOM PERFECTLY MACHINED
- HIGH CARBON STEEL CUTTER (HARDENED AND TEMPERED)



TO ORDER :

With or Without Knob

SIZE	
mm	inches
140	5.1/2
175	7



SS-2348

SPOKE SHAVE PLANE

- FINEST IRON CASTING
- HIGH CARBON STEEL CUTTER (HARDENED AND TEMPERED)



SIZE		LENGTH	
mm	inches	mm	inches
54	2.1/8	250	10

SS-2355

G-CLAMP

- DROP FORGED & MALLEABLE IRON FRAME WITH STEEL SCREW



TO ORDER :
 (A) Plain Base
 (B) Corrugated Base

SIZE	
mm	inches
25	1
50	2
75	3
100	4
150	6
200	8
250	10
300	12

SS-2358

T-BAR CLAMP

- JAW MADE OF SPECIAL MALLEABLE CASTING



SIZE FEET
2
2½
3
4
5
6



Premium Hand Tools

SS-2310

BENCH VICE FIXED BASE

- BODY MADE OF CAST IRON
- JAWS MADE OF SPECIAL CARBON STEEL

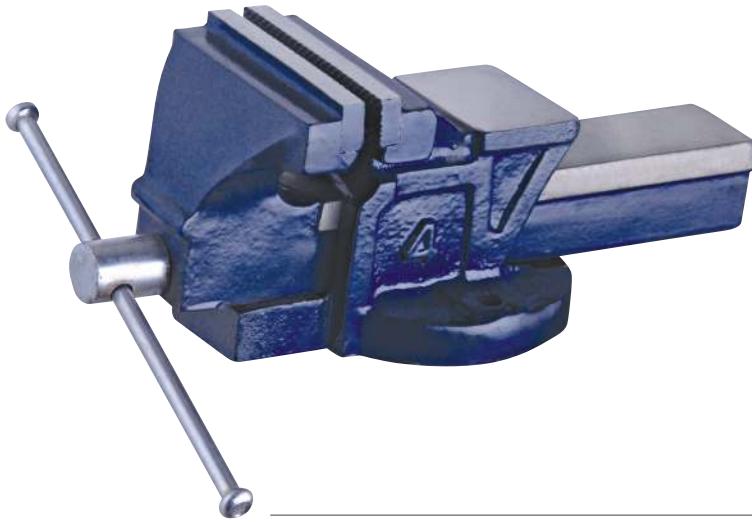

SIZE		LENGTH OF JAW mm	HEIGHT OF JAW mm	OPENING OF JAW mm
mm	inches			
65	2-1/2	65	50	65
80	3	80	55	80
90	3-1/2	90	60	100
100	4	100	70	105
112	4-1/2	112	75	125
125	5	125	85	130
150	6	150	90	165
200	8	200	105	225
250	10	250	225	275
300	12	300	260	325

SS-2315

BENCH VICE SWIVEL BASE

- BODY MADE OF CAST IRON
- JAWS MADE OF SPECIAL CARBON STEEL

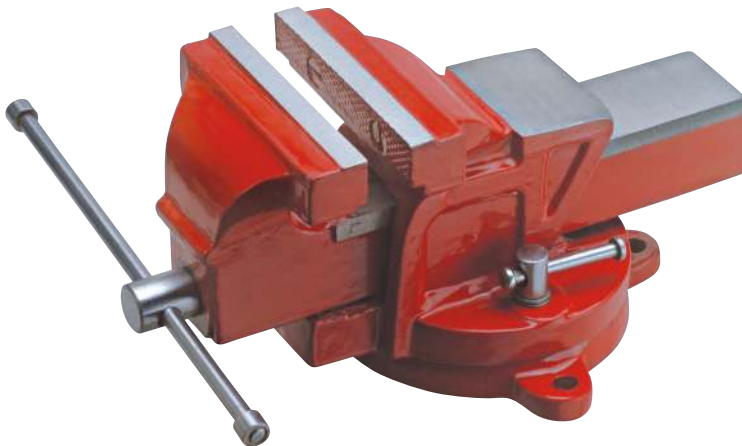

SIZE		LENGTH OF JAW mm	HEIGHT OF JAW mm	OPENING OF JAW mm
mm	inches			
80	3	80	50	80
100	4	100	70	100
125	5	125	85	130
150	6	150	90	165
200	8	200	105	225

SS-2319

PIPE VICE SELF LOCKING

- FRAME MADE OUT OF MALLEABLE IRON
- JAWS MADE OUT OF CARBON STEEL
DULY HARDENED & KNURLED



SIZE	
mm	inches
150	6
175	7
200	8
250	10



SS-2325

TUBULAR HACKSAW FRAME WITH PLASTIC HANDLE

- CHROME PLATED TUBULAR FRAME
- HEAVY DUTY PLASTIC HANDLE



TO ORDER :
• With or without Blade

SIZE		Tube Dia
mm	inches	
250	10	5/8"
300	12	5/8"

SS-2326

TUBULAR HACKSAW FRAME ADJUSTABLE WITH STEEL HANDLE

- CHROME PLATED TUBULAR FRAME
- RANGE 250MM AND 300MM



TO ORDER :
• With or without Blade

SS-2327

HACKSAW FRAME FIXED WITH WOODEN HANDLE

- MANUFACTURED FROM STEEL FLAT AND FITTED WITH SEASONED WOODEN HANDLE



TO ORDER :
• With or without Blade
• Colour to Choice

Thickness of Frame 4mm to 6mm

SIZE	
mm	inches
300	12

SS-2330

JUNIOR HACKSAW FRAME

- MADE OUT OF STEEL RODS
- 5mm or 6mm Rod Dia Meter



(a) Plastic Handle
(b) Steel Handle

TO ORDER :
• With or without Blade
• Colour to Choice

Rod Dia 5mm or 6mm

SIZE	
mm	inches
150	6



Premium Hand Tools

SS-2401

PICK AXE CHISEL & POINTED

- BODY MADE OF HIGH CARBON STEEL
- EDGES MAY BE POLISHED OR SILVER PAINTED
- AVAILABLE IN ROUND AND OVAL EYE



L mm	B mm	EYE Ø	Wt. LBS
650	60	65x40	7
545	65	60x40	5

L mm	B mm	EYE Ø	Wt. LBS
475	90	75x40	5
475	90	70x40	4.5

SS-2403

DIGGING SPADE

- BODY MADE OF HIGH CARBON STEEL



L mm	B mm	EYE Ø	Wt. LBS
230	240	45	1.4
230	240	45	1.2

SS-2405

DIGGING FORK

- BODY MADE OF HIGH CARBON STEEL

Available in Round / Oval Eye



L mm	B mm	EYE Ø	Wt. LBS
250	200	45	4
250	200	45	3.5



Infrastructure.....

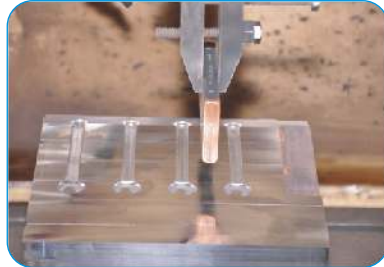



Premium Hand Tools

ESS ESS EXPORTS
ESS ESS FORGINGS
HAPPY MACHINE TOOLS

Industrial Area - C, Kanganwal Road, V.P.O. Jugiana, G.T. Road, Ludhiana - 141 017, Punjab, INDIA
Ph. : +91 161 2510359, 2510049 Fax : +91 161 2510331
E-mail : essessexport@gmail.com / info@essessexports.com / vivek@essessexports.com
Website : www.essessexports.com